

YUSON

shower hoses and faucet hoses
for 2024



Yuson 雍成
WE BRING YOU VALUE

Shanghai Yuson Industry Co., Ltd | Yuson Group Limited(HK)

A: 18F No. 1690 Kongjiang Road, Shanghai, 200092, China

T: +8621 61075090, 61428791, 61428790

E: yuson@yusongroup.com

W: <https://www.yusongroup.com>



scan  to learn more

The content of this catalogue is limited, Yuson has abilities to provide OEM and ODM services for all our customers. If you don't find your favorite product in our catalogue, please contact our team at the first time, we will provide you with a one-stop solution according to your specific needs.

Copyright © Shanghai Yuson Industry Co.,Ltd. All Rights Reserved.



01

Shower Hose Series

SUS Double-Lock Hoses	01
BRASS Double-Lock Hoses	05
PVC Hoses	11
NYLON Hoses	16

02

Special Hose For Shattaf Series

SUS Explosion-Proof Hoses	19
TPU Telephone WireHoses	22

03

Braided Hose Series

25

04

Kitchen Hose Series

29

05

Packaging Display

31

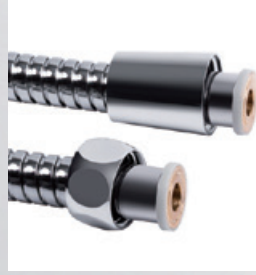

METAL DOUBLE-LOCK SHOWER HOSE



不锈钢双扣淋浴软管

SUS Double-Lock Shower Hose

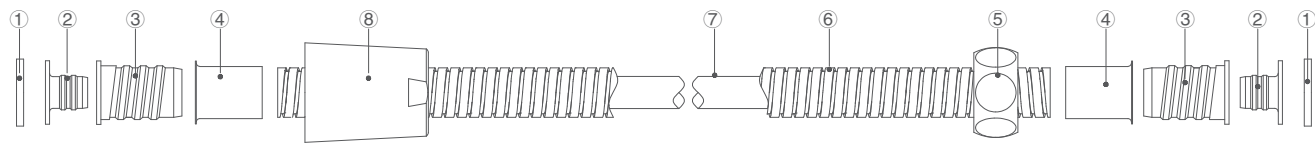
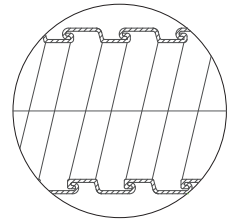

| PARAMETER

NO.	1	2	3	4	5	6	7	8
Name	Washer	Insert	Connector	Sleeve	G1/2 Ball Nut	Outer Tube	Inner Tube	G1/2 Conical Nut
Material	EPDM or SILICONE	BRASS SUS POM	PA6.6	SUS201 or 304	BRASS or ABS	SUS201 202 301 304	PVC EPDM PEX TPV	BRASS or ABS
Test Items	Torsion	Tensile Strength	Resistance To Flexing	Burst Pressure	Working Pressure	Working Temperature	Flow Rate Class 1	Flow Rate Class 2
OGH Executive Standard	≥25N.m	≥750N	≥5000 cycles (F of 5N)	≥3.0Mpa	0.6Mpa	0°C -75°C	≥25.2L/M (0.3Mpa)	20L/M<Q<25.2 L/M(0.3Mpa)

| CHOOSE COLOR

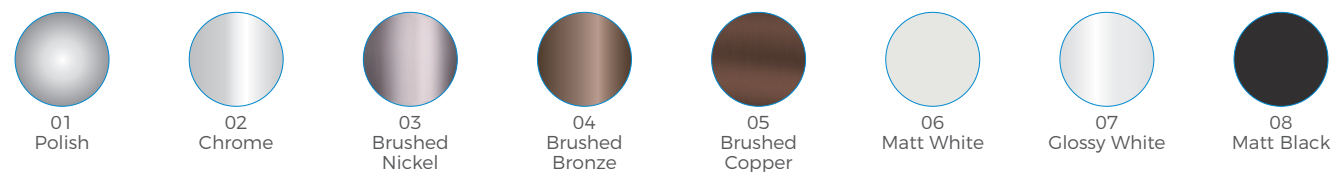

Item No.:

S1C01N02-L-01



S1 → SUS201

S2 → SUS202



Double-Lock Hose

Models:

OPTION 选配

G1/2 CONICAL NUT



S1EC01N02-L-01

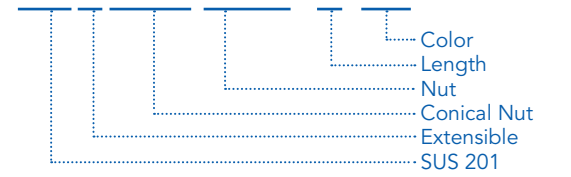

S3 → SUS301

S4 → SUS304



Extensible Double-Lock Hose

Models:

OPTION 选配

G1/2 NUT



带自旋不锈钢双扣淋浴软管

Anti-Twist SUS Double-Lock Shower Hose

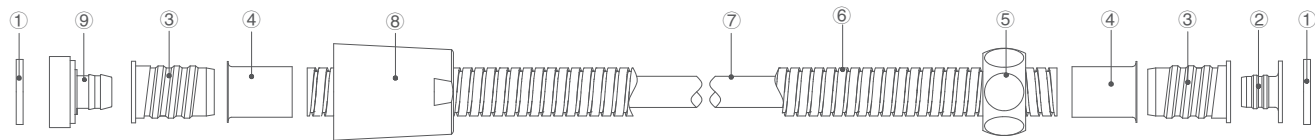
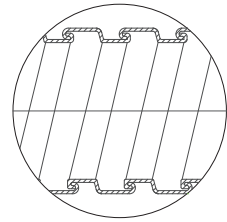

PARAMETER

NO.	1	2	3	4	5	6	7	8	9
Name	Washer	Insert	Connector	Sleeve	G1/2 Ball Nut	Outer Tube	Inner Tube	G1/2 Conical Nut	Anti-Twist Insert
Material	EPDM or SILICONE	BRASS SUS POM	PA6.6	SUS201 or 304	BRASS or ABS	SUS201 202 301 304	PVC EPDM PEX TPV	BRASS or ABS	BRASS or POM
Test Items	Torsion	Tensile Strength	Resistance To Flexing	NSS	Burst Pressure	Working Pressure	Working Temperature	Flow Rate Class 1	Flow Rate Class 2
OGH Executive Standard	≥25N.m	≥750N	≥5000 cycles (F of 5N)	96h 200h	≥3.0Mpa	0.6Mpa	0°C -75°C	≥25.2L/M (0.3Mpa)	20L/M<Q< 25.2L/M (0.3Mpa)

CHOOSE COLOR

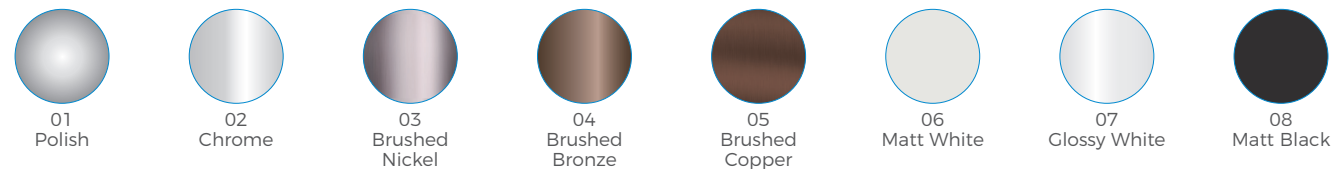

Item No.:

S1C3N01-L-01AT*



S1 → SUS201

S2 → SUS202

S3 → SUS301

S4 → SUS304



AT1



Double-Lock Hose

Models:

OPTION 选配

G1/2 CONICAL NUT



C 1 (BRASS)

C 2 (BRASS)



C 3 (BRASS)

C 4 (BRASS)



C 5 (BRASS)

C 6 (BRASS)



C 7 (BRASS)

C 8 (ABS)



S1EC1N01-L-01AT*

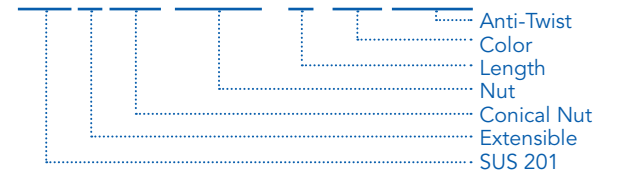

AT2

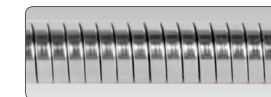

Extensible
Double-Lock Hose

Models:

OPTION 选配

G1/2 NUT



N 01 (BRASS)



N 02 (BRASS)



N 03 (BRASS)



N 04 (BRASS)



N 05 (BRASS)



N 06 (BRASS)



N 07 (ABS)



N 08 (ABS)



N 09 (ABS)



N 10 (ABS)

铜双扣淋浴软管

Brass Double-Lock Shower Hose

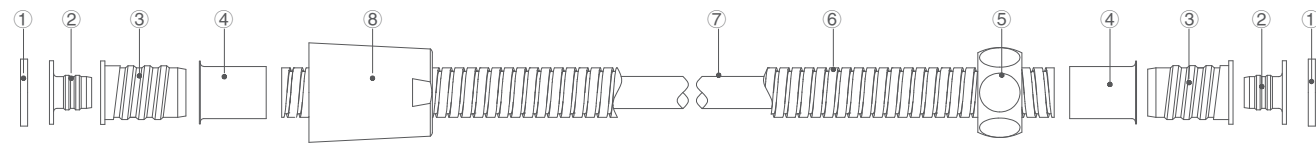
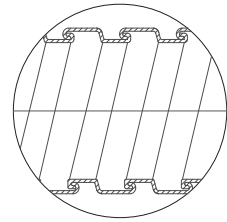

PARAMETER

NO.	1	2	3	4	5	6	7	8
Name	Washer	Insert	Connector	Sleeve	G1/2 Ball Nut	Outer Tube	Inner Tube	G1/2 Conical Nut
Material	EPDM or SILICONE	BRASS SUS POM	PA6.6	SUS 304	BRASS or ABS	BRASS(H62)	PVC EPDM PEX TPV	BRASS or ABS
Test Items	Torsion	Tensile Strength	Resistance To Flexing	Burst Pressure	Working Pressure	Working Temperature	Flow Rate Class 1	Flow Rate Class 2
OGH Executive Standard	≥25N.m	≥500N	≥5000 cycles (F of 5N)	≥3.0Mpa	0.6Mpa	0°C -75°C	≥25.2L/M (0.3Mpa)	20L/M<Q<25.2 L/M(0.3Mpa)

CHOOSE COLOR



Item No.:

BC01N02-L-01

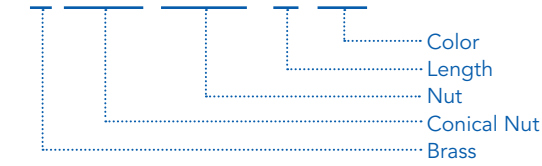

Double-Lock Hose

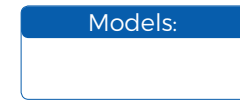

OPTION 选配

G1/2 CONICAL NUT



BEC01N02-L-01

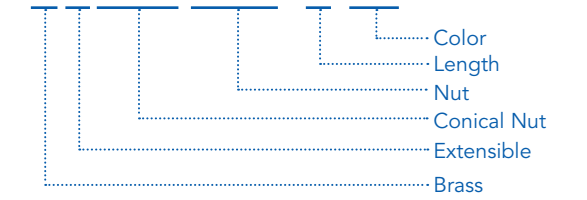

Extensible
Double-Lock Hose

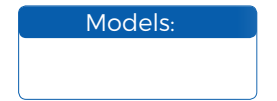

OPTION 选配

G1/2 NUT

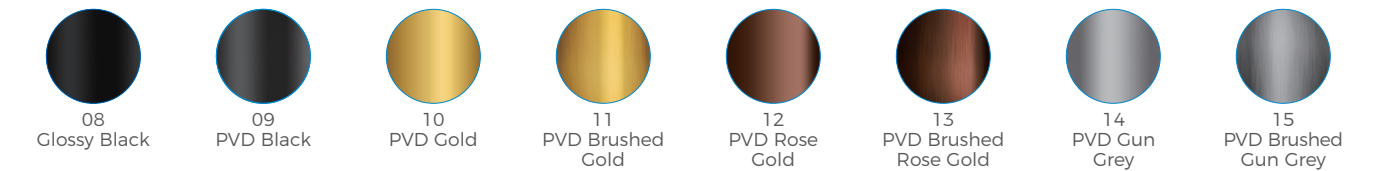

带自旋铜双扣淋浴软管

Anti-Twist Brass Double-Lock Shower Hose

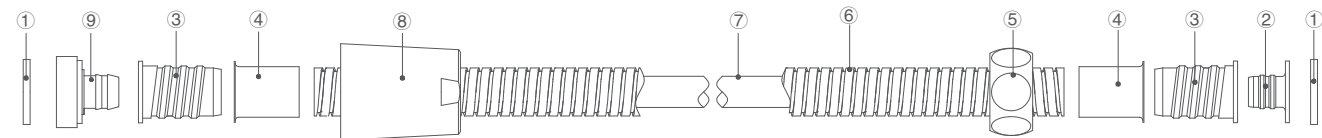
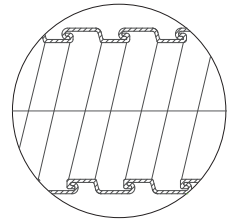

PARAMETER

NO.	1	2	3	4	5	6	7	8	9
Name	Washer	Insert	Connector	Sleeve	G1/2 Ball Nut	Outer Tube	Inner Tube	G1/2 Conical Nut	Anti-Twist Insert
Material	EPDM or SILICONE	BRASS SUS POM	PA6.6	SUS 304	BRASS or ABS	BRASS (H62)	PVC EPDM PEX TPV	BRASS or ABS	BRASS or POM
Test Items	Torsion	Tensile Strength	Resistance To Flexing	NSS	Burst Pressure	Working Pressure	Working Temperature	Flow Rate Class 1	Flow Rate Class 2
OGH Executive Standard	≥25N.m	≥500N	≥5000 cycles (F of 5N)	96h 200h	≥3.0Mpa	0.6Mpa	0°C -75°C	≥25.2L/M (0.3Mpa)	20L/M<Q<25.2L/M (0.3Mpa)

CHOOSE COLOR



Item No.:

BC3N02-L-01AT*

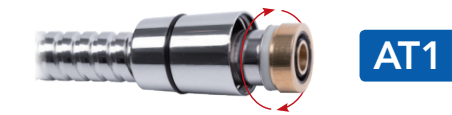
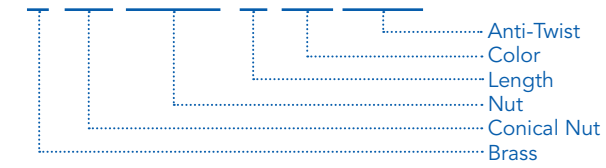

AT1



Double-Lock Hose

Models:

OPTION 选配

G1/2 CONICAL NUT



C 1 (BRASS)

C 2 (BRASS)



C 3 (BRASS)

C 4 (BRASS)



C 5 (BRASS)

C 6 (BRASS)



C 7 (BRASS)

C 8 (ABS)

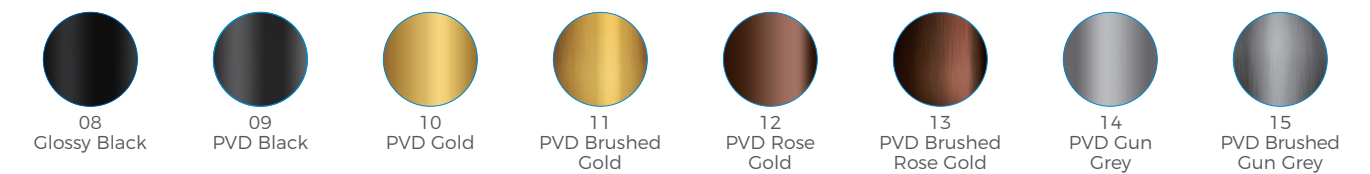

BEC1N02-L-01AT*

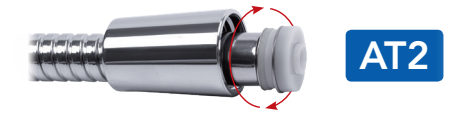
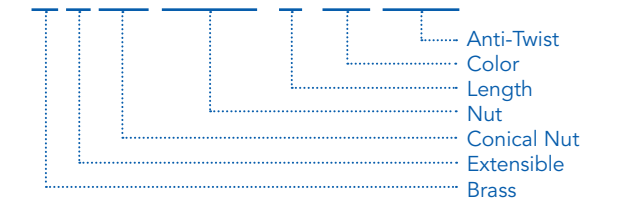

AT2



Extensible Double-Lock Hose

Models:

OPTION 选配

G1/2 NUT



N 01 (BRASS)

N 02 (BRASS)



N 03 (BRASS)

N 04 (BRASS)



N 05 (BRASS)

N 06 (BRASS)



N 07 (ABS)

N 08 (ABS)



N 09 (ABS)

N 10 (ABS)

PVC
SHOWER HOSE SERIES
PVC 淋浴软管系列



PVC 淋浴软管

PVC Shower Hose



P001

PVC 白底银丝管
White Silver PVC Hose

软管材质 Material	PVC
锥形螺母 G1/2 Conical Nut	BRASS or ABS
螺母 G1/2 Nut	BRASS or ABS
芯子 Insert	BRASS or POM
拉力 Tensile Strength	350N
爆破压力 Burst Pressure(Mpa)	2.0Mpa
工作温度 Working Temperature	0-75°C
长度范围 Length	0.5m-3m



P002

PVC 灰底银丝管
Grey Silver PVC Hose

软管材质 Material	PVC
锥形螺母 G1/2 Conical Nut	BRASS or ABS
螺母 G1/2 Nut	BRASS or ABS
芯子 Insert	BRASS or POM
拉力 Tensile Strength	350N
爆破压力 Burst Pressure(Mpa)	2.0Mpa
工作温度 Working Temperature	0-75°C
长度范围 Length	0.5m-3m



P003

PVC 黑底银丝管
Black Silver PVC Hose

软管材质 Material	PVC
锥形螺母 G1/2 Conical Nut	BRASS or ABS
螺母 G1/2 Nut	BRASS or ABS
芯子 Insert	BRASS or POM
拉力 Tensile Strength	350N
爆破压力 Burst Pressure(Mpa)	2.0Mpa
工作温度 Working Temperature	0-75°C
长度范围 Length	0.5m-3m

PVC 淋浴软管

PVC Shower Hose



P004

PVC 黑底凹凸管
Black Concavo-Convex PVC Hose

软管材质 Material	PVC
锥形螺母 G1/2 Conical Nut	BRASS or ABS
螺母 G1/2 Nut	BRASS or ABS
芯子 Insert	BRASS or POM
拉力 Tensile Strength	500N
爆破压力 Burst Pressure(Mpa)	2.0Mpa
工作温度 Working Temperature	0-75°C
长度范围 Length	0.5m-3m



P006

PVC 透明加密 3.0 银丝管
Transparent 3.0 Silver PVC Hose

软管材质 Material	PVC
锥形螺母 G1/2 Conical Nut	BRASS or ABS
螺母 G1/2 Nut	BRASS or ABS
芯子 Insert	BRASS or POM
拉力 Tensile Strength	500N
爆破压力 Burst Pressure(Mpa)	2.5Mpa
工作温度 Working Temperature	0-75°C
长度范围 Length	0.5m-3m



P005

PVC 透明加密 2.0 银丝管
Transparent 2.0 Silver PVC Hose

软管材质 Material	PVC
锥形螺母 G1/2 Conical Nut	BRASS or ABS
螺母 G1/2 Nut	BRASS or ABS
芯子 Insert	BRASS or POM
拉力 Tensile Strength	500N
爆破压力 Burst Pressure(Mpa)	2.5Mpa
工作温度 Working Temperature	0-75°C
长度范围 Length	0.5m-3m



P007

PVC 透明加密 4.0 银丝管
Transparent 4.0 Silver PVC Hose

软管材质 Material	PVC
锥形螺母 G1/2 Conical Nut	BRASS or ABS
螺母 G1/2 Nut	BRASS or ABS
芯子 Insert	BRASS or POM
拉力 Tensile Strength	500N
爆破压力 Burst Pressure(Mpa)	2.5Mpa
工作温度 Working Temperature	0-75°C
长度范围 Length	0.5m-3m

PVC 淋浴软管

PVC Shower Hose



P008

PVC 哑白管
Matt White PVC Hose

软管材质 Material	PVC
锥形螺母 G1/2 Conical Nut	BRASS or ABS
螺母 G1/2 Nut	BRASS or ABS
芯子 Insert	BRASS or POM
拉力 Tensile Strength	500N
爆破压力 Burst Pressure(Mpa)	2.5Mpa
工作温度 Working Temperature	0-75°C
长度范围 Length	0.5m-3m



P009

PVC 哑黑管
Matt Black PVC Hose

软管材质 Material	PVC
锥形螺母 G1/2 Conical Nut	BRASS or ABS
螺母 G1/2 Nut	BRASS or ABS
芯子 Insert	BRASS or POM
拉力 Tensile Strength	500N
爆破压力 Burst Pressure(Mpa)	2.5Mpa
工作温度 Working Temperature	0-75°C
长度范围 Length	0.5m-3m

PVC 淋浴软管

PVC Shower Hose



P012

PVC 银粉管
Matt Silver PVC Hose

软管材质 Material	PVC
锥形螺母 G1/2 Conical Nut	BRASS or ABS
螺母 G1/2 Nut	BRASS or ABS
芯子 Insert	BRASS or POM
拉力 Tensile Strength	500N
爆破压力 Burst Pressure(Mpa)	2.5Mpa
工作温度 Working Temperature	0-75°C
长度范围 Length	0.5m-3m



P013

PVC 亮银管
Shiny PVC Hose

软管材质 Material	PVC
锥形螺母 G1/2 Conical Nut	BRASS or ABS
螺母 G1/2 Nut	BRASS or ABS
芯子 Insert	BRASS or POM
拉力 Tensile Strength	500N
爆破压力 Burst Pressure(Mpa)	2.5Mpa
工作温度 Working Temperature	0-75°C
长度范围 Length	0.5m-3m



P010

PVC 亮黑管
Glossy Black PVC Hose

软管材质 Material	PVC
锥形螺母 G1/2 Conical Nut	BRASS or ABS
螺母 G1/2 Nut	BRASS or ABS
芯子 Insert	BRASS or POM
拉力 Tensile Strength	500N
爆破压力 Burst Pressure(Mpa)	2.5Mpa
工作温度 Working Temperature	0-75°C
长度范围 Length	0.5m-3m



P011

PVC 枪灰管
Gun Grey PVC Hose

软管材质 Material	PVC
锥形螺母 G1/2 Conical Nut	BRASS or ABS
螺母 G1/2 Nut	BRASS or ABS
芯子 Insert	BRASS or POM
拉力 Tensile Strength	500N
爆破压力 Burst Pressure(Mpa)	2.5Mpa
工作温度 Working Temperature	0-75°C
长度范围 Length	0.5m-3m



P014

PVC 玫瑰金管
Rose Gold PVC Hose

软管材质 Material	PVC
锥形螺母 G1/2 Conical Nut	BRASS or ABS
螺母 G1/2 Nut	BRASS or ABS
芯子 Insert	BRASS or POM
拉力 Tensile Strength	500N
爆破压力 Burst Pressure(Mpa)	2.5Mpa
工作温度 Working Temperature	0-75°C
长度范围 Length	0.5m-3m



P015

PVC 镭金管
Gold PVC Hose

软管材质 Material	PVC
锥形螺母 G1/2 Conical Nut	BRASS or ABS
螺母 G1/2 Nut	BRASS or ABS
芯子 Insert	BRASS or POM
拉力 Tensile Strength	500N
爆破压力 Burst Pressure(Mpa)	2.5Mpa
工作温度 Working Temperature	0-75°C
长度范围 Length	0.5m-3m

PVC 淋浴软管

PVC Shower Hose



P016

PVC 白色透明网纹管
White Transparent Mesh PVC Hose

软管材质 Material	PVC
锥形螺母 G1/2 Conical Nut	BRASS or ABS
螺母 G1/2 Nut	BRASS or ABS
芯子 Insert	BRASS or POM
拉力 Tensile Strength	500N
爆破压力 Burst Pressure(Mpa)	2.5Mpa
工作温度 Working Temperature	0-75°C
长度范围 Length	0.5m-3m



P017

PVC 白底网纹管
White Mesh PVC Hose

软管材质 Material	PVC
锥形螺母 G1/2 Conical Nut	BRASS or ABS
螺母 G1/2 Nut	BRASS or ABS
芯子 Insert	BRASS or POM
拉力 Tensile Strength	500N
爆破压力 Burst Pressure(Mpa)	2.5Mpa
工作温度 Working Temperature	0-75°C
长度范围 Length	0.5m-3m



P018

PVC 灰底网纹管
Grey Mesh PVC Hose

软管材质 Material	PVC
锥形螺母 G1/2 Conical Nut	BRASS or ABS
螺母 G1/2 Nut	BRASS or ABS
芯子 Insert	BRASS or POM
拉力 Tensile Strength	500N
爆破压力 Burst Pressure(Mpa)	2.5Mpa
工作温度 Working Temperature	0-75°C
长度范围 Length	0.5m-3m

尼龙淋浴软管

Nylon Shower Hose



N001

灰色尼龙淋浴管
Grey Nylon Shower Hose

内管材质 Inner Tube	PE
外层材料 Outer Material	Nylon
锥形螺母 G1/2 Conical Nut	BRASS or ABS
芯子 Insert	BRASS or POM
拉力 Tensile Strength	500N
爆破压力 Burst Pressure(Mpa)	2.5Mpa
工作温度 Working Temperature	0-75°C
长度范围 Length	0.5m-3m



N002

黑色尼龙淋浴管
Black Nylon Shower Hose

内管材质 Inner Tube	PE
外层材料 Outer Material	Nylon
锥形螺母 G1/2 Conical Nut	BRASS or ABS
芯子 Insert	BRASS or POM
拉力 Tensile Strength	500N
爆破压力 Burst Pressure(Mpa)	2.5Mpa
工作温度 Working Temperature	0-75°C
长度范围 Length	0.5m-3m



N003

枪灰色尼龙淋浴管
Gun Grey Nylon Shower Hose

内管材质 Inner Tube	PE
外层材料 Outer Material	Nylon
锥形螺母 G1/2 Conical Nut	BRASS or ABS
芯子 Insert	BRASS or POM
拉力 Tensile Strength	500N
爆破压力 Burst Pressure(Mpa)	2.5Mpa
工作温度 Working Temperature	0-75°C
长度范围 Length	0.5m-3m



SPECIAL HOSE FOR
SHATTAE SERIES
妇洗防爆软管系列

不锈钢双扣防爆妇洗软管

SUS Double-Lock Explosion-Proof Shattaf Hose

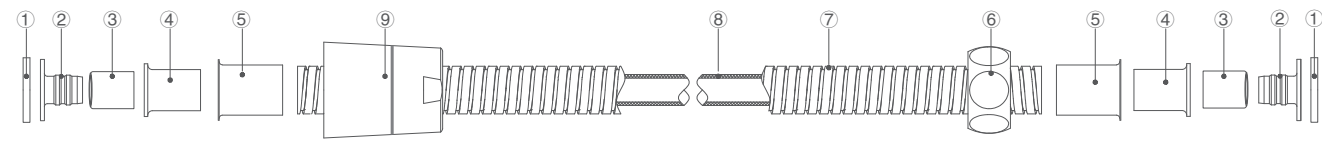
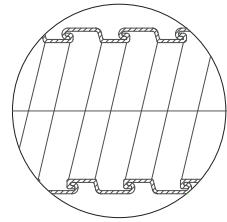

PARAMETER

NO.	1	2	3	4	5	6	7	8	9
Name	Washer	Insert	Sleeve	Inner Sleeve	Outer Sleeve	G1/2 Ball Nut	Outer Tube	Inner Tube	G1/2 Conical Nut
Material	EPDM or SILICONE	BRASS	SUS 304	SUS201 or 304	SUS201 or 304	BRASS or SUS	SUS201 202 301 304	PVC+PET EPDM+PET	BRASS or SUS
Test Items	Torsion	Tensile Strength	Resistance To Flexing	NSS	Burst Pressure	Working Pressure	Working Temperature	Flow Rate Class 1	Flow Rate Class 2
OGH Executive Standard	≥25N.m	≥750N	≥5000 cycles (F of 5N)	96h 200h	≥7.0Mpa	0.6Mpa	0°C -75°C	≥25.2L/M (0.3Mpa)	20L/M<Q<25.2L/M (0.3Mpa)

CHOOSE COLOR

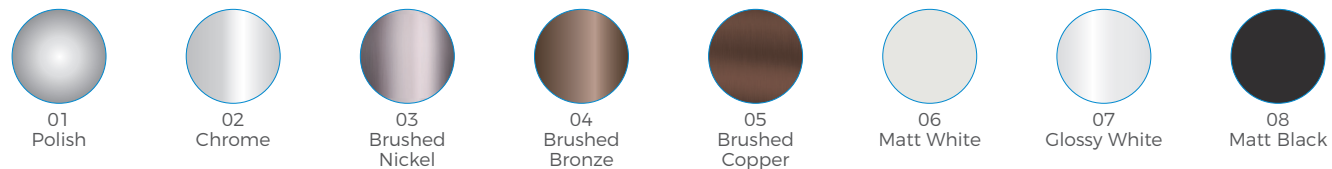

Item No.:

S1C03N02-L-01EP



S1 → SUS201

S2 → SUS202



Double-Lock Hose

Models:

OPTION 选配

G1/2 CONICAL NUT



S1EC03N02-L-01EP

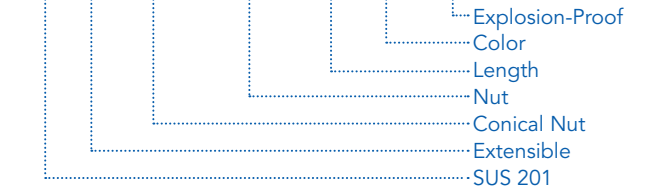

S3 → SUS301

S4 → SUS304



Extensible Double-Lock Hose

Models:

OPTION 选配

G1/2 NUT



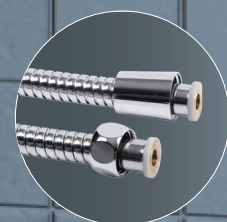

Flexible



Refined copper interface



Sustainable Water Pressure
Away From Water Leakage

TPU 电话线妇洗软管

TPU Telephone Wire Shattaf Hose



GTC01-EP

灰色聚醚电话线管
Grey TPU Telephone Wire Hose

软管材质 Material	TPU
锥形螺母 G1/2 Conical Nut	BRASS or ABS
螺母 G1/2 Nut	BRASS or ABS
芯子 Insert	BRASS
拉力 Tensile Strength	500N
爆破压力 Burst Pressure(Mpa)	3.0Mpa
工作温度 Working Temperature	0-75°C
长度范围 Length	2m-4m



GGTC01-EP

枪灰聚醚电话线管
Gun Grey TPU Telephone Wire Hose

软管材质 Material	TPU
锥形螺母 G1/2 Conical Nut	BRASS or ABS
螺母 G1/2 Nut	BRASS or ABS
芯子 Insert	BRASS
拉力 Tensile Strength	500N
爆破压力 Burst Pressure(Mpa)	3.0Mpa
工作温度 Working Temperature	0-75°C
长度范围 Length	2m-4m



BTC01-EP

黑色聚醚电话线管
Black TPU Telephone Wire Hose

软管材质 Material	TPU
锥形螺母 G1/2 Conical Nut	BRASS or ABS
螺母 G1/2 Nut	BRASS or ABS
芯子 Insert	BRASS
拉力 Tensile Strength	500N
爆破压力 Burst Pressure(Mpa)	3.0Mpa
工作温度 Working Temperature	0-75°C
长度范围 Length	2m-4m



WTC01-EP

白色聚醚电话线管
White TPU Telephone Wire Hose

软管材质 Material	TPU
锥形螺母 G1/2 Conical Nut	BRASS or ABS
螺母 G1/2 Nut	BRASS or ABS
芯子 Insert	BRASS
拉力 Tensile Strength	500N
爆破压力 Burst Pressure(Mpa)	3.0Mpa
工作温度 Working Temperature	0-75°C
长度范围 Length	2m-4m

BRAIDED HOSE SERIES

编织管系列



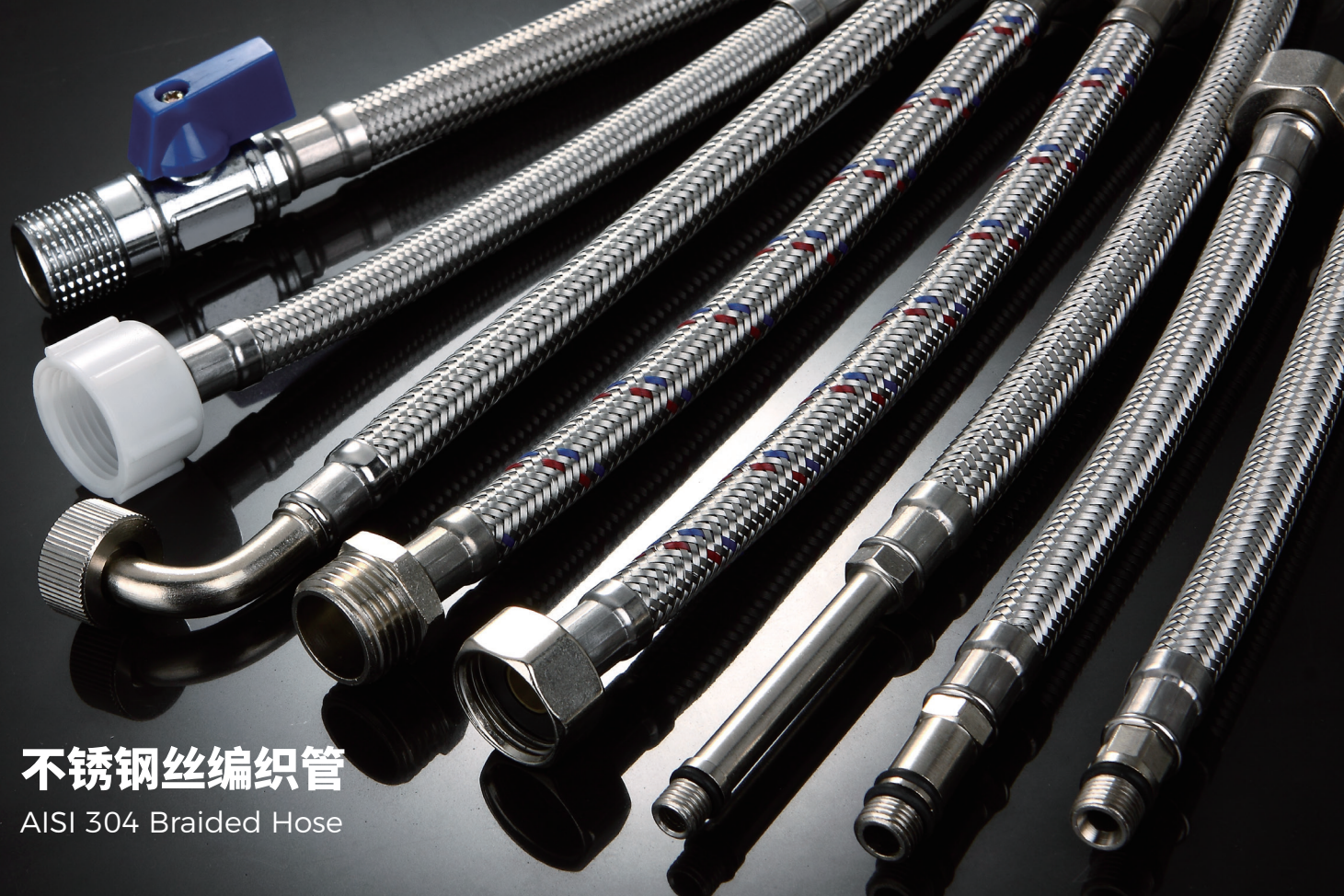

不锈钢丝编织管

AISI 304 Braided Hose

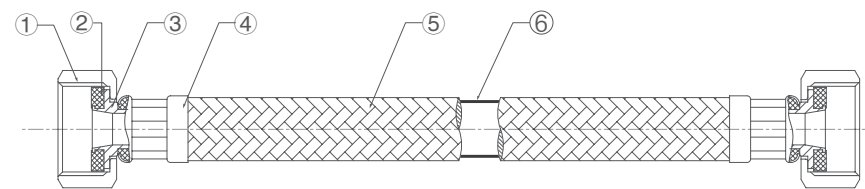

序号	名称	材料
①	六角帽	黄铜
②	嵌入垫片	三元乙丙
③	加长芯子	黄铜
④	钢套	304 不锈钢
⑤	不锈钢丝	304 不锈钢
⑥	内管	EPDM

NO.	NAME	MATERIAL
①	Hexagonal Nut	BRASS
②	Washer	EPDM
③	Insert	BRASS
④	Sleeve	AISI 304
⑤	S.S Braided	AISI 304
⑥	Inner Tube	EPDM

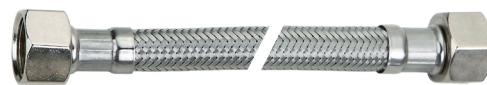

FF

NO. 编号	Inner Tube 内管	Outer Diameter(mm) 外径	Description 规格	Working Temperature(°C) 工作温度	Working Pressure(Mpa) 工作压力	Burst Pressure(Mpa) 爆破压力	Length(cm) 长度范围	Remark 备注
F1001	PVC EPDM(ACS / WARS) PEX(KTW-BWGL) TPV(NSF)	Φ10	F3/8C * F3/8C	0-75°C PVC 0-90°C	0.6Mpa	8Mpa	20-300	
F1002			F3/8C * F1/2					
F1003		F1/2 * F1/2						
F1004		F3/8 * F3/8						
F1005		F3/8 * F1/2						
F1006		F1/2 * F1/2						
F1007		F1/2 * F1/2						
F1008		F1/2 * F3/4						
F1009		F3/4 * F3/4						
F1010		F1/2 * F1/2						
F1011		F1/2 * F3/4						
F1012		F3/4 * F3/4						
F1013		Φ20	F3/4 * F3/4					
F1014		Φ22	F1 * F1					

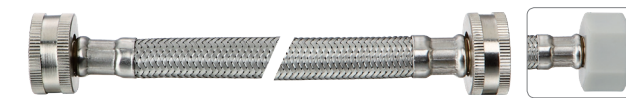

FF

NO. 编号	Inner Tube 内管	Outer Diameter(mm) 外径	Description 规格	Working Temperature(°C) 工作温度	Working Pressure(Mpa) 工作压力	Burst Pressure(Mpa) 爆破压力	Length(cm) 长度范围	Remark 备注
F2001	PVC	Φ14	F3/4 * F3/4	0-75°C	0.6Mpa	8Mpa	20-300	
F2002	EPDM(ACS/WARS)	Φ17	F3/4 * F3/4	0-90°C				



FF

F3001	PVC	Φ12	F3/8C * F7/8	0-75°C PVC	0.6Mpa	8Mpa	20-300	
F3002	TPV(NSF)	Φ14	F1/2 * F7/8	0-90°C				



FE

F4001	PVC	Φ12	F3/8C * F3/8CE	0-75°C PVC	0.6Mpa	8Mpa	20-300	
F4002			F3/8 * F3/8E					
F4003	EPDM(ACS / WARS)	Φ12	F1/2 * F3/8E	0-90°C	0.6Mpa	8Mpa	20-300	
F4004			F1/2 * F1/2E					
F4005	PEX(KTW-BWGL)	Φ17	F1/2 * F1/2E	0-90°C	0.6Mpa	8Mpa	30-300	
F4006			F1/2 * F3/4E					
F4007	TPV(NSF)	Φ17	F3/4 * F3/4E					



FM

F5001	PVC EPDM(ACS / WARS) PEX(KTW-BWGL) TPV(NSF)	Φ12	F3/8C * M3/8C	0-75°C PVC 0-90°C	0.6Mpa	8Mpa	20-300	
F5002			F3/8 * M3/8					
F5003			F3/8 * M1/2					
F5004		F1/2 * M3/8						
F5005		F1/2 * M1/2						
F5006		F1/2 * M1/2						
F5007		F1/2 * M3/4						
F5008		F3/4 * M3/4						
F5009		F1/2 * M1/2						
F5010		F1/2 * M3/4						
F5011		F3/4 * M3/4						
F5012		Φ20	F3/4 * M3/4					
F5013		Φ22	F1 * M1					

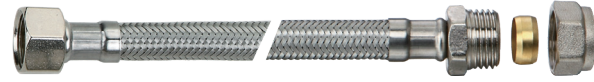

◀F.FM▶

NO. 编号	Inner Tube 内管	Outer Diameter(mm) 外径	Description 规格	Working Temperature(°C) 工作温度	Working Pressure(Mpa) 工作压力	Burst Pressure(Mpa) 爆破压力	Length(cm) 长度范围	Remark 备注	
F6001	PVC EPDM(ACS / WARS) PEX(KTW-BWGL) TPV(NSF)	Φ12	F3/8 * FM3/8C	0-75°C PVC 0-90°C	0.6Mpa	8Mpa	20-300		
F6002			F3/8 * FM3/8						
F6003			F3/8 * FM1/2						
F6004			F1/2 * FM3/8						
F6005			F1/2 * FM1/2						
F6006		F1/2 * FM1/2	Φ14					F3/4 * FM1/2	
F6007		F3/4 * FM1/2							
F6008		F3/4 * FM3/4							
F6009		F1/2 * FM1/2	Φ16					F3/4 * FM1/2	
F6010		F3/4 * FM1/2							
F6011		F3/4 * FM3/4							



◀V.F.FM▶

NO. 编号	Inner Tube 内管	Outer Diameter(mm) 外径	Description 规格	Working Temperature(°C) 工作温度	Working Pressure(Mpa) 工作压力	Burst Pressure(Mpa) 爆破压力	Length(cm) 长度范围	Remark 备注	
F7001	EPDM(ACS / WARS) PEX(KTW-BWGL) TPV(NSF)	Φ14	F3/8 * FM1/2	0-90°C	0.6Mpa	8Mpa	20-300		
F7002			F1/2 * FM1/2						
F7003			F3/4 * FM1/2						
F7004			F3/4 * FM3/4						
F7005		F1/2 * FM1/2	Φ16					F3/4 * FM1/2	
F7006		F3/4 * FM1/2							
F7007		F3/4 * FM3/4							



◀V.F.M▶

NO. 编号	Inner Tube 内管	Outer Diameter(mm) 外径	Description 规格	Working Temperature(°C) 工作温度	Working Pressure(Mpa) 工作压力	Burst Pressure(Mpa) 爆破压力	Length(cm) 长度范围	Remark 备注
F8001	EPDM(ACS / WARS)	Φ14	VALVE F3/8 * FM1/2	0-90°C	0.6Mpa	8Mpa	20-300	

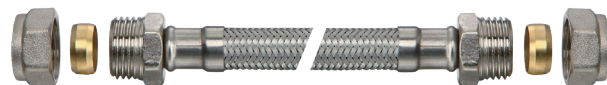

◀FM.FM▶

NO. 编号	Inner Tube 内管	Outer Diameter(mm) 外径	Description 规格	Working Temperature(°C) 工作温度	Working Pressure(Mpa) 工作压力	Burst Pressure(Mpa) 爆破压力	Length(cm) 长度范围	Remark 备注	
F9001	EPDM(ACS / WARS) PEX(KTW-BWGL) TPV(NSF)	Φ12	FM3/8 * FM3/8	0-90°C	0.6Mpa	8Mpa	20-300		
F9002			FM3/8 * FM1/2						
F9003		FM1/2 * FM1/2	Φ14					FM1/2 * FM1/2	
F9004		FM1/2 * FM1/2							

不锈钢丝编织管

AISI 304 Braided Hose

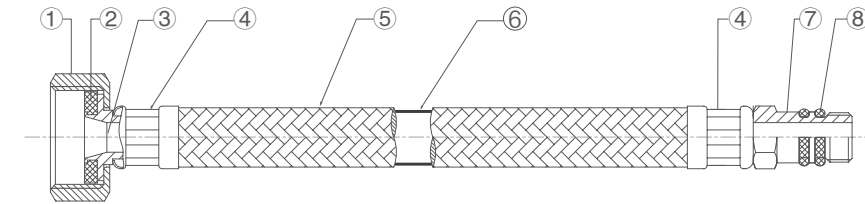

序号	名称	材料
①	六角帽	黄铜
②	嵌入垫片	三元乙丙
③	加长芯子	黄铜
④	钢套	304 不锈钢
⑤	不锈钢丝	304 不锈钢
⑥	内管	EPDM
⑦	单头杆	黄铜
⑧	O-ring	NBR

NO.	NAME	MATERIAL
①	Hexagonal Nut	BRASS
②	Washer	EPDM
③	Insert	BRASS
④	Sleeve	AISI 304
⑤	S.S Braided	AISI 304
⑥	Inner Tube	EPDM
⑦	Male	BRASS
⑧	O-ring	NBR



◀F.FM▶

NO. 编号	Inner Tube 内管	Outer Diameter(mm) 外径	Description 规格	Working Temperature(°C) 工作温度	Working Pressure(Mpa) 工作压力	Burst Pressure(Mpa) 爆破压力	Length(cm) 长度范围	Remark 备注	
F10001	EPDM(ACS / WARS) PEX(KTW-BWGL) TPV(NSF)	Φ10	F3/8 * M8	0-90°C	0.6Mpa	6.5Mpa	15-100		
F10002			F3/8 * M10						
F10003			F1/2 * M8						
F10004			F1/2 * M10						
F10005		F3/8 * M8	Φ11					F3/8 * M10	
F10006		F3/8 * M10							
F10007		F1/2 * M8							
F10008		F1/2 * M10	Φ12					F3/8 * M8	
F10009		F3/8 * M8							
F10010		F3/8 * M10							
F10011		F3/8 * M12							
F10012		F1/2 * M8							
F10013		F1/2 * M10							
F10014		F1/2 * M12							

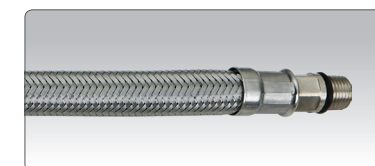

M8*1	L 18	O-Ring: 9.3*6.1*1.6
M10*1	L 18	O-Ring: 11*7.6*1.7
M12*1	L 18	O-Ring: 12.7*8.9*1.9

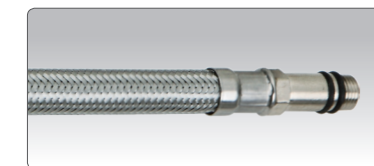

M8*1	L 45	O-Ring: 9.3*6.1*1.6
M10*1	L 45	O-Ring: 11*7.6*1.7
M12*1	L 45	O-Ring: 12.7*8.9*1.9

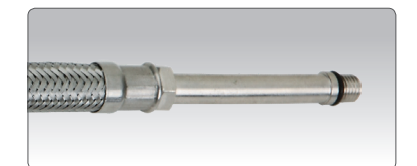

M8*1	L 90	O-Ring: 9.3*6.1*1.6
M10*1	L 90	O-Ring: 11*7.6*1.7

厨房抽拉软管

Kitchen Hose Series

尼龙抽拉软管

Nylon Hose For Kitchen

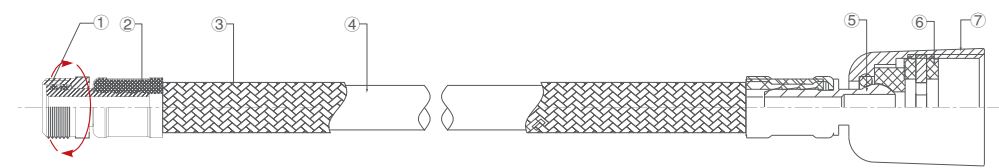

PARAMETER

NO.	1	2	3	4	5	6	7
Name	M15*1	Sleeve	Nylon Braided	Inner Tube	Anti-Twist Insert	Washer	G1/2 Conical Nut
Material	BRASS	SUS 304	Nylon	PEX	BRASS	EPDM or SILICONE	BRASS
Test Items	Torsion	Tensile Strength	Burst Pressure	Working Pressure	Working Temperature	Flow Rate Class	
OGH Executive Standard	≥20N.m	≥500N	≥3.0Mpa	0.6Mpa	0°C -75°C	20L/M<Q<25.2 L/M(0.3Mpa)	
NO.	Description		Outer Diameter(mm)		Length(cm)		
KH1001	F1/2*M15 * 1		φ12.5 or φ13.5		100-200		
KH1002	F1/2*quick connector						



M12*1 M15*1



Quick Connector

厨房抽拉软管

Kitchen Hose Series

不锈钢双扣抽拉管

SUS Double-Lock Hose For Kitchen

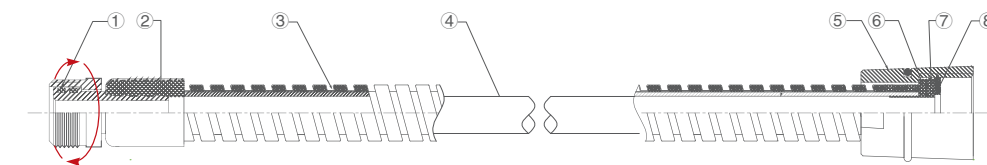

PARAMETER

NO.	1	2	3	4	5	6	7	8
Name	M15*1	Sleeve	Outer Tube	Inner Tube	G1/2 Conical Nut	Connector	Insert	Washer
Material	BRASS	SUS 304	SUS or BRASS	PVC EPDM PEX	BRASS	PA6.6	BRASS	EPDM or SILICONE
Test Items	Torsion	Tensile Strength	Resistance To Flexing	Nss	Burst Pressure	Working Pressure	Working Temperature	Flow Rate Class 1
OGH Executive Standard	≥25N.m	≥750N	≥5000 cycles (F of 5N)	96h 200h	≥3.0Mpa	0.6Mpa	0°C -75°C	≥25.2L/M (0.3Mpa)
NO.	Description		Outer Diameter(mm)		Length(cm)			
KH1003	F1/2*M15 * 1		φ12.5 or φ14		100-200			

CHOOSE COLOR

